

Schlitz Nr. 0



Inbus 2.5 mm



24 V

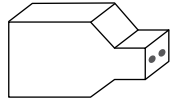

S-Bus

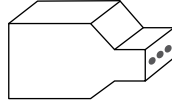

Befestigungs-Set

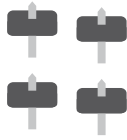

A

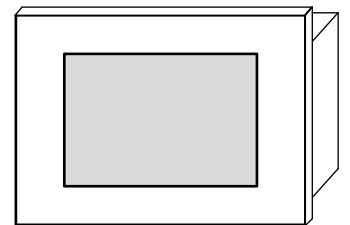
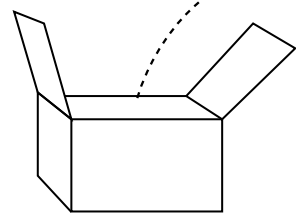

PCD7.D457ET7F (5.7")
PCD7.D410ET7F (10.4")

B

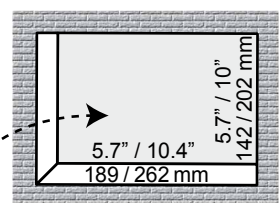
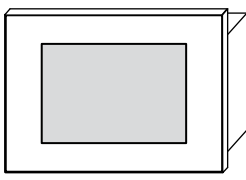

C

1

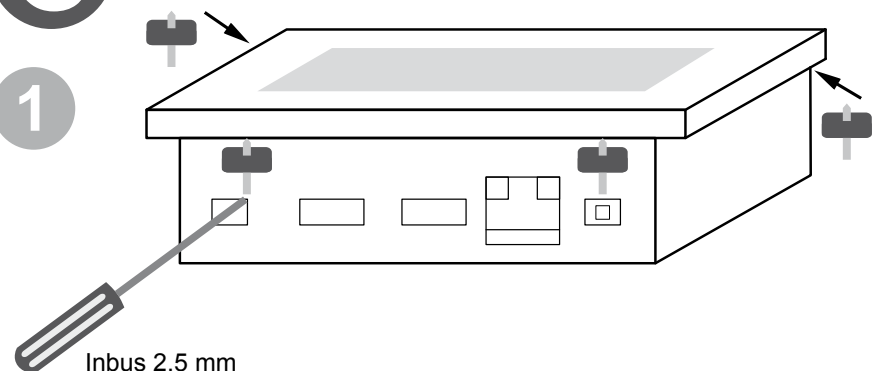

Inbus 2.5 mm

2

optional Inwall Mounting Kit
PCD7.Dxx-IWS

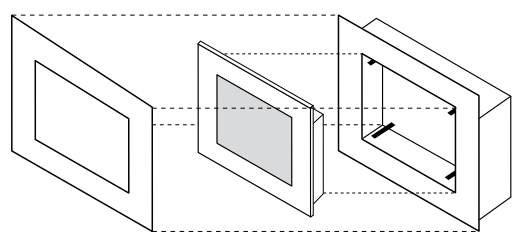

3

optional Onwall Mounting Kit
PCD7.Dxx-OWS

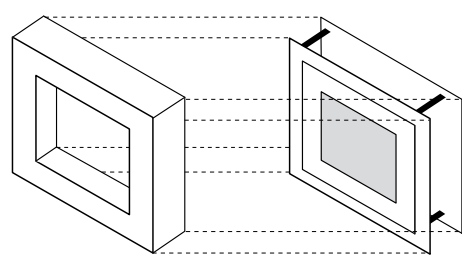

4

optional All-In-One Kit

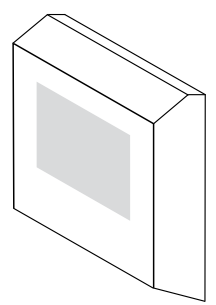

D

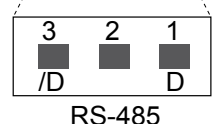
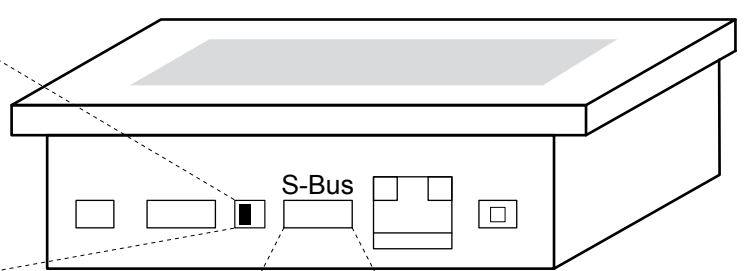
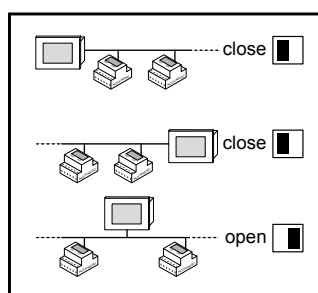

RS-485

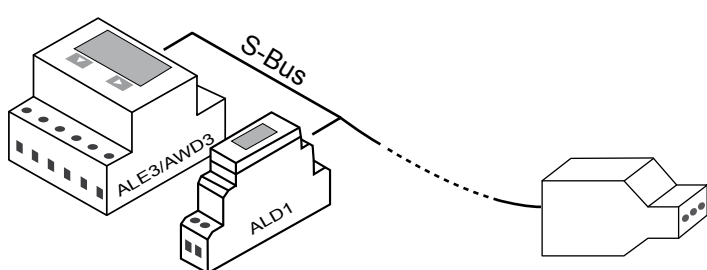

E

optional Netzteil
24 VDC 2.5A
Q.PS-AD2-2402F

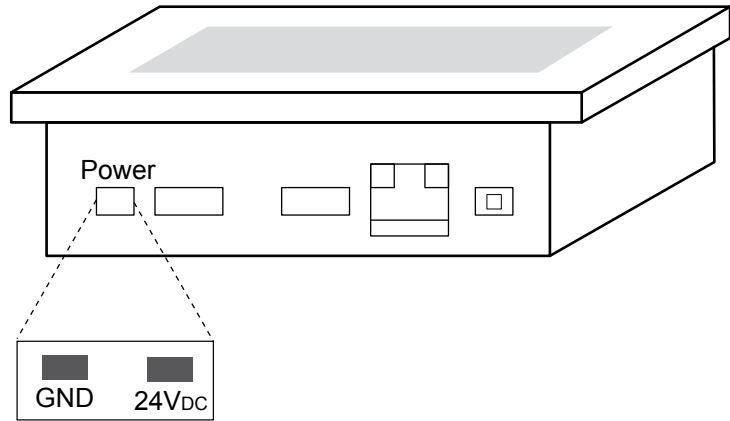
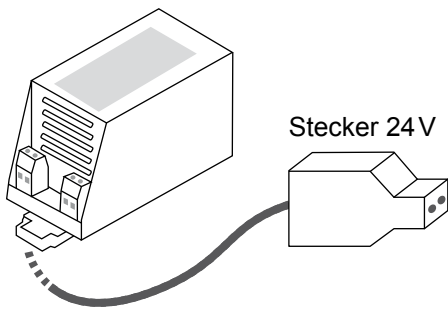

optional Ethernet

F

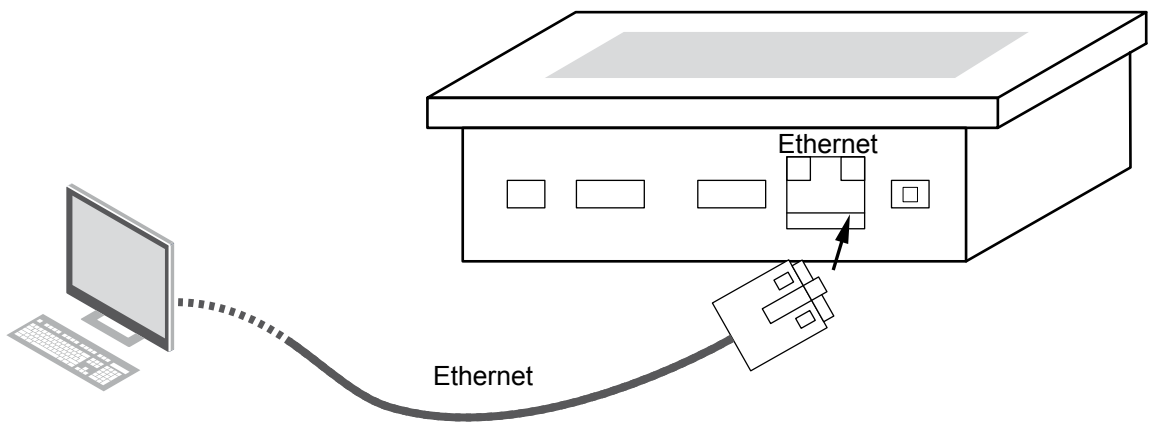

G

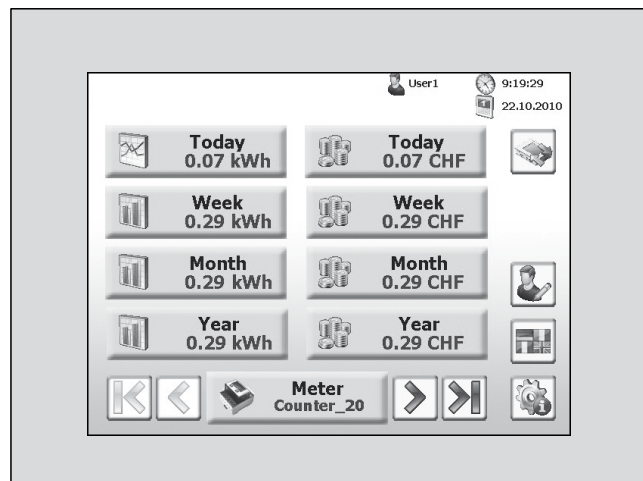
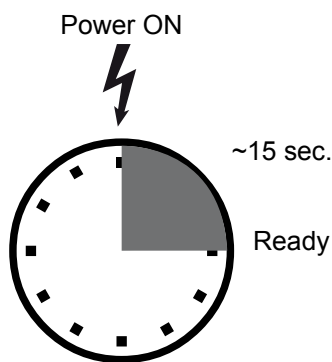



Name optional

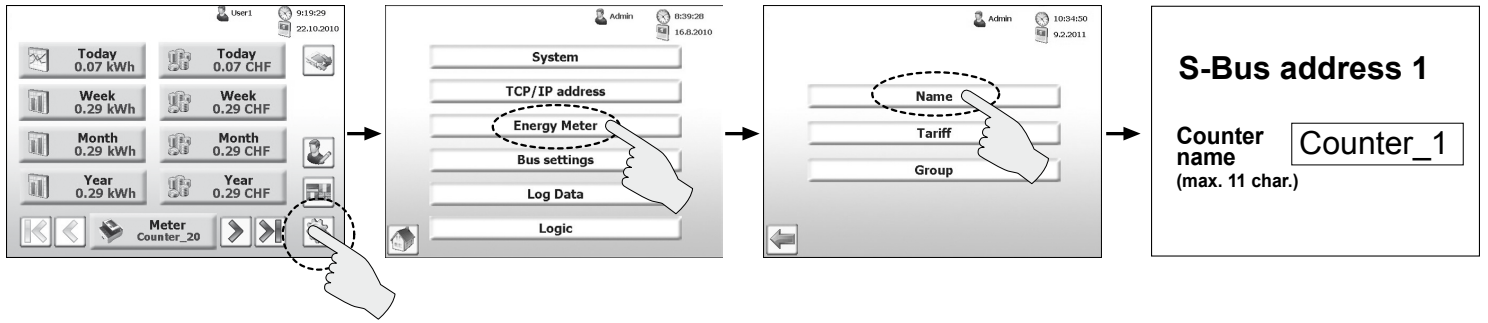

Tarif optional

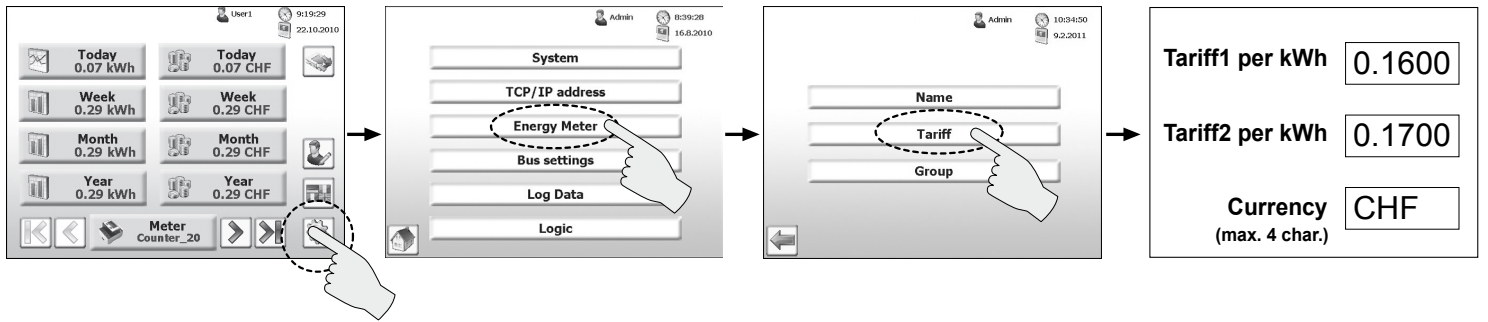

TCP / IP optional

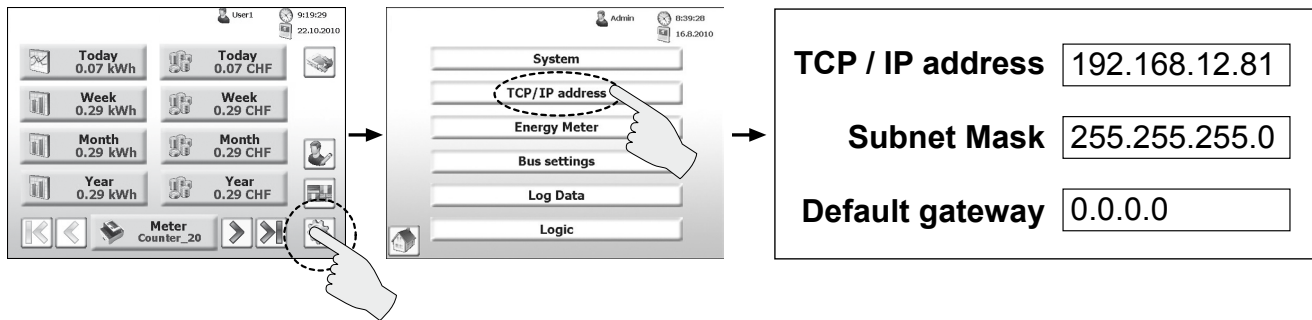

Benutzer wechseln

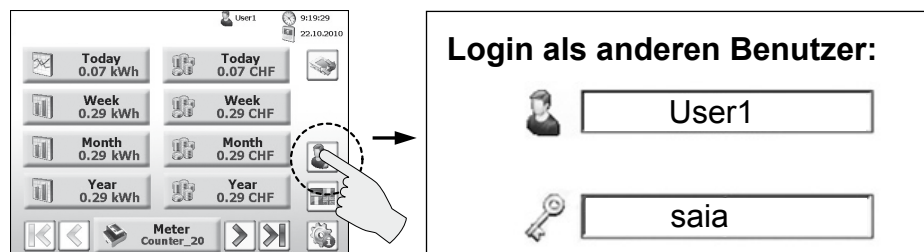

Pozi Nr. 1



Schlitz Nr. 0



\varnothing 1.5 – 16 mm²

\varnothing < 2.5 mm²
für Tarif E1/E2

\varnothing CY 0.5...0.75 mm²
für S-Bus

1

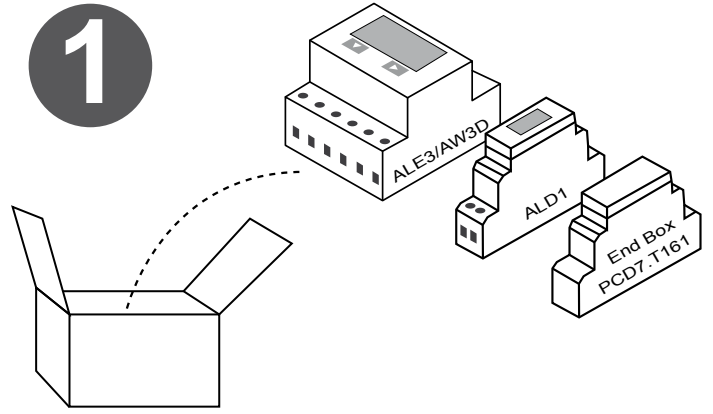

2

Energiezähler installieren

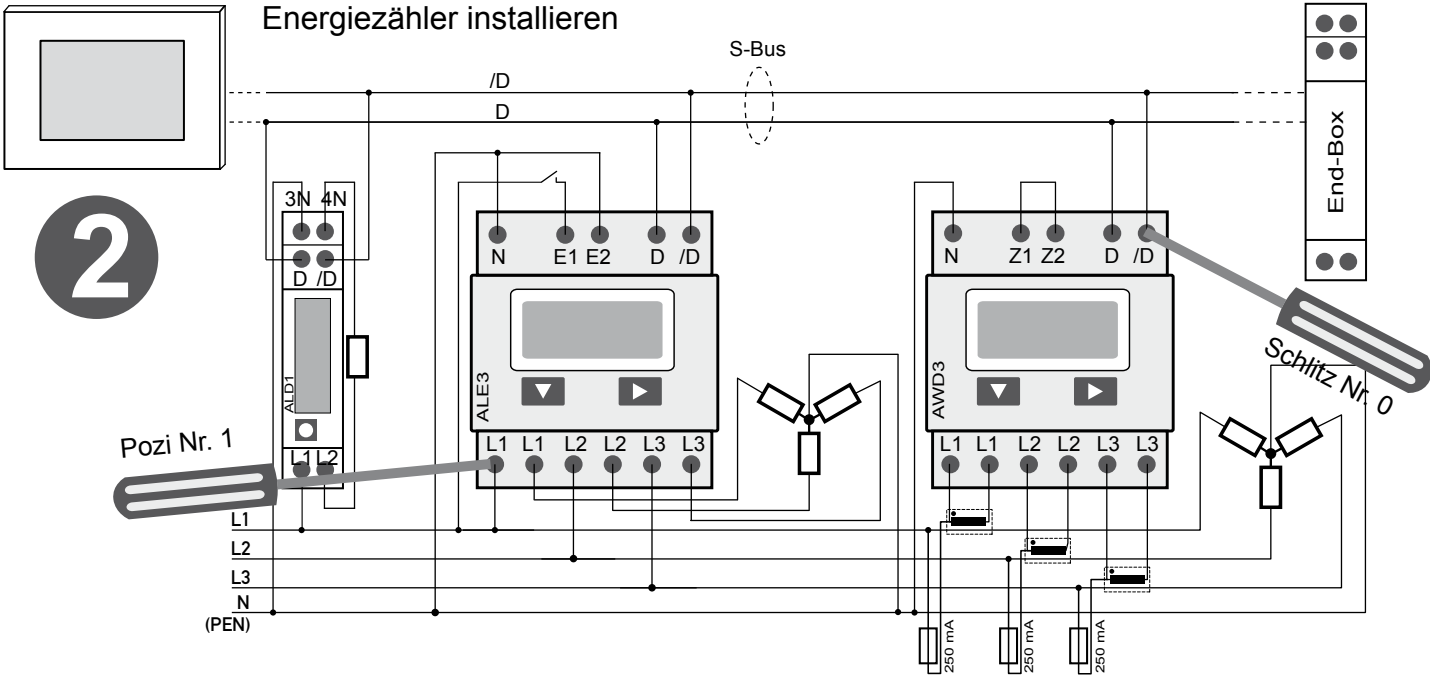

1 Wandlerverhältnis AWD3

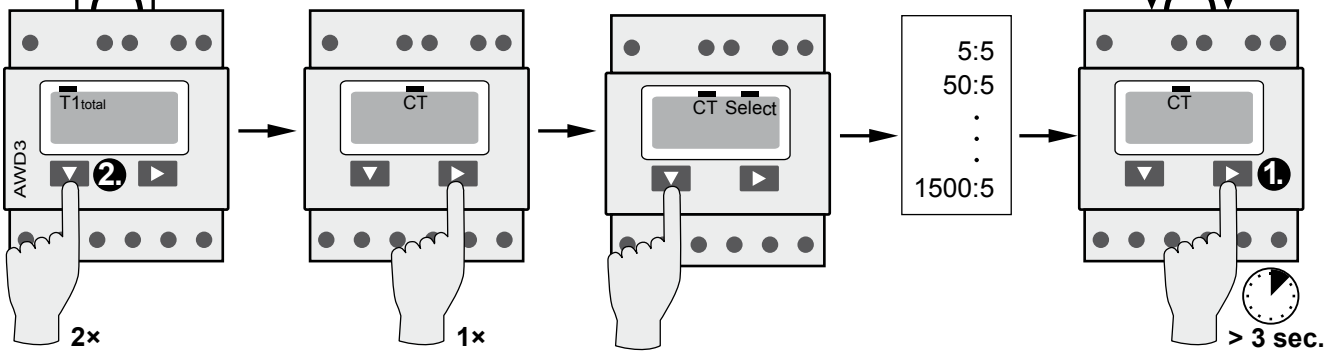

3

S-Bus Adresse

